

DESCRIPTION

SRC Devices two electrode line protectors are designed for a high degree of surge protection in AC line applications at low cost. The two models, AC120 and AC240, are designed for use with AC120VAC and 240VAC lines, respectively. These gaps are able to extinguish in the presence of AC follow-on currents of at least 300A. AC line protectors function as switches and therefore handle currents that far surpass other types of transient voltage protection.

FEATURES

- High AC follow-on current capability (>300A-pk)
- Small size
- Rugged ceramic-metal construction
- Low capacitance (<1pF)
- Available with or without leads
- Available in tape-and-reel packaging

APPLICATIONS

- Long branch circuits (AC wall outlet)
- Short branch circuits (at breaker box, computer, etc)
- Power supplies
- Test equipment
- Submersible pumps
- Medical electronics

RATINGS @ 25°C

AGENCY APPROVALS

- UL1449 recognized (AC120)
- Meets IEEE C62.41-1991
- CSA approved

| Parameter | Min | Nom | Max | Units |
|---------------------------|------------------|-----|------|-------|
| DC Breakdown voltage | | | | |
| AC120 | 225 | - | 500 | V |
| AC240 | 425 | - | 715 | V |
| Impulse Breakdown voltage | | | | |
| AC120 | - | - | 700 | V |
| AC240 | - | - | 800 | V |
| Insulation resistance | 10 ¹⁰ | - | - | Ohms |
| Capacitance | - | - | 1 | pF |
| Operational temperature | -40 | - | +125 | °C |

(See detailed specifications for more information)

SPECIFICATIONS

All characteristics at 25 °C

| Parameters | Conditions | AC120L | | | AC240L | | | Units |
|------------------------|----------------------|------------------|-----|------|------------------|-----|------|-------|
| | | Min | Nom | Max | Min | Nom | Max | |
| Device specifications | | | | | | | | |
| DC breakdown n | 100 V/sec | 225 | - | 500 | 425 | - | 715 | V |
| Impulse breakdown n | 100 V/useg | - | - | 700 | - | - | 800 | V |
| Insulation resistance | 100 V | 10 ¹⁰ | - | - | 10 ¹⁰ | - | - | Ohms |
| Capacitance | 1 MHz | - | - | 1.0 | - | - | 1.0 | pF |
| Arc voltage | I=5A min | - | 20 | - | - | 20 | - | V |
| Life ratings(1) | | | | | | | | |
| Max current surge | 10KA (8/20us) | 4 | - | - | 4 | - | - | Shots |
| AC Current | 10 times;1 sec;60 Hz | - | N/A | - | - | N/A | - | A |
| AC Follow -On Current | 1/2 cycle @ 60Hz | - | - | >300 | - | - | >300 | A pk |

¹End-of-Life limits are:
 DC: same as minimum initial DC breakdown n voltage limit.
 Impulse: less than breakdown n limit + 50%.

MECHANICAL DIMENSIONS

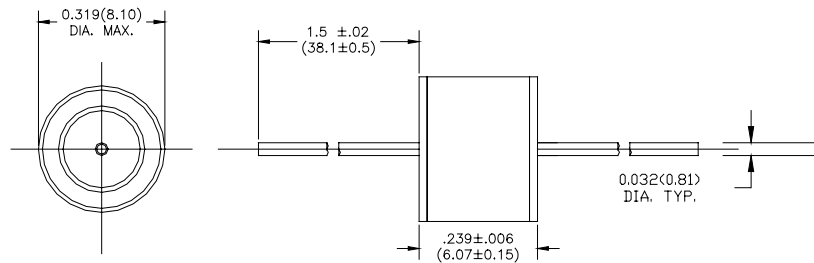

ORDERING INFORMATION

