

# ESD9B, SZESD9B

## ESD Protection Diode Micro-Packaged Diodes for ESD Protection

The ESD9B Series is designed to protect voltage sensitive components from ESD. Excellent clamping capability, low leakage, and fast response time provide best in class protection on designs that are exposed to ESD. Because of its small size, it is suited for use in cellular phones, MP3 players, digital cameras and many other portable applications where board space comes at a premium.

### Specification Features

- Low Capacitance 15 pF
- Low Clamping Voltage
- Small Body Outline Dimensions: 0.039" x 0.024" (1.0mm x 0.60mm)
- Low Body Height: 0.016" (0.4 mm)
- Stand-off Voltage: 3.3 V, 5 V
- Low Leakage
- Response Time is < 1 ns
- IEC61000-4-2 Level 4 ESD Protection
- AEC-Q101 Qualified and PPAP Capable
- SZ Prefix for Automotive and Other Applications Requiring Unique Site and Control Change Requirements
- This is a Pb-Free Device

### Mechanical Characteristics

**CASE:** Void-free, transfer-molded, thermosetting plastic  
Epoxy Meets UL 94 V-0

**LEAD FINISH:** 100% Matte Sn (Tin)

**MOUNTING POSITION:** Any

**QUALIFIED MAX REFLOW TEMPERATURE:** 260°C  
Device Meets MSL 1 Requirements

### MAXIMUM RATINGS

| Rating  | Symbol                            | Value       | Unit |
|---|-----------------------------------|-------------|------|
| IEC 61000-4-2 (ESD)<br>Contact<br>Air                                     |                                   | ±18<br>±18  | kV   |
| IEC 61000-4-4 (EFT)   |                                   | 40          | A    |
| Total Power Dissipation on FR-5 Board<br>(Note 1) @ T <sub>A</sub> = 25°C | P <sub>D</sub>                    | 300         | mW   |
| Thermal Resistance, Junction-to-Ambient                                   | R <sub>θJA</sub>                  | 400         | °C/W |
| Junction and Storage Temperature Range                                    | T <sub>J</sub> , T <sub>stg</sub> | -55 to +150 | °C   |
| Lead Solder Temperature - Maximum<br>(10 Second Duration)                 | T <sub>L</sub>                    | 260         | °C   |

Stresses exceeding those listed in the Maximum Ratings table may damage the device. If any of these limits are exceeded, device functionality should not be assumed, damage may occur and reliability may be affected.

1. FR-5 = 1.0 x 0.75 x 0.62 in.



ON Semiconductor®

[www.onsemi.com](http://www.onsemi.com)



SOD-923  
CASE 514AB

### MARKING DIAGRAM



X = Specific Device Code  
M = Date Code

### ORDERING INFORMATION

| Device         | Package              | Shipping†        |
|----------------|----------------------|------------------|
| ESD9B3.3ST5G   | SOD-923<br>(Pb-Free) | 8000/Tape & Reel |
| ESD9B5.0ST5G   | SOD-923<br>(Pb-Free) | 8000/Tape & Reel |
| SZESD9B5.0ST5G | SOD-923<br>(Pb-Free) | 8000/Tape & Reel |

†For information on tape and reel specifications, including part orientation and tape sizes, please refer to our Tape and Reel Packaging Specifications Brochure, BRD8011/D.

# ESD9B, SZESD9B

## ELECTRICAL CHARACTERISTICS

( $T_A = 25^\circ\text{C}$  unless otherwise noted)

| Symbol    | Parameter   |
|-----------|---|
| $I_{PP}$  | Maximum Reverse Peak Pulse Current                        |
| $V_C$     | Clamping Voltage @ $I_{PP}$                               |
| $V_{RWM}$ | Working Peak Reverse Voltage                              |
| $I_R$     | Maximum Reverse Leakage Current @ $V_{RWM}$               |
| $V_{BR}$  | Breakdown Voltage @ $I_T$                                 |
| $I_T$     | Test Current  |
| C         | Capacitance @ $V_R = 0\text{ V}$ and $f = 1.0\text{ MHz}$ |

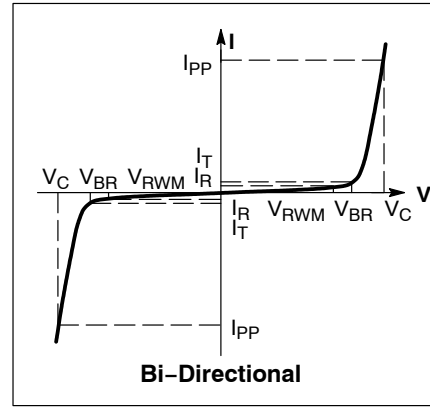

## ELECTRICAL CHARACTERISTICS ( $T_A = 25^\circ\text{C}$ unless otherwise noted)

| Device                          | Device Marking | $V_{RWM}$ (V) | $I_R$ (nA) @ $V_{RWM}$ | $V_{BR}$ (V) @ $I_T$ (Note 2) |     | $I_T$ (mA) | C (pF) | $V_C$ (V)<br>Per IEC61000-4-2 (Note 3) | $V_C$ (V)<br>Max Per 8 x 20 $\mu\text{s}$ (Note 4) |                       |
|---------------------------------|----------------|---------------|------------------------|-------------------------------|-----|------------|--------|--|--|-----------------------|
|                                 |                | Max           | Max                    | Min                           | Max |            |        |  | $I_{PP} = 1\text{ A}$                              | $I_{PP} = 2\text{ A}$ |
| ESD9B3.3ST5G                    | 2*             | 3.3           | 100                    | 5.0                           | 7.0 | 1.0        | 15     | Figures 1 and 2<br>See Below           | 10.5   | 11.5                  |
| ESD9B5.0ST5G,<br>SZESD9B5.0ST5G | E              | 5.0           | 100                    | 5.8                           | 7.8 | 1.0        | 15     | Figures 1 and 2<br>See Below           | 12.5   | 15.0                  |

Product parametric performance is indicated in the Electrical Characteristics for the listed test conditions, unless otherwise noted. Product performance may not be indicated by the Electrical Characteristics if operated under different conditions.

\* Rotated  $270^\circ$ .

- $V_{BR}$  is measured with a pulse test current  $I_T$  at an ambient temperature of  $25^\circ\text{C}$ .
- For test procedure see Figures 3 and 4 and Application Note AND8307/D.
- Surge current waveforms per Figure 5.

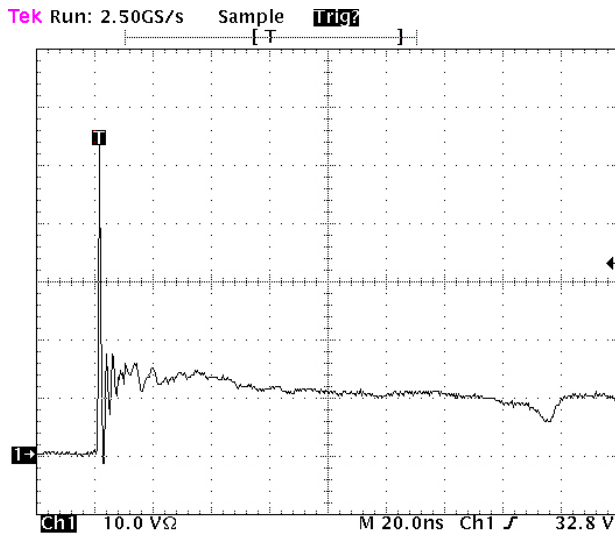

Figure 1. ESD Clamping Voltage Screenshot Positive 8 kV Contact per IEC61000-4-2

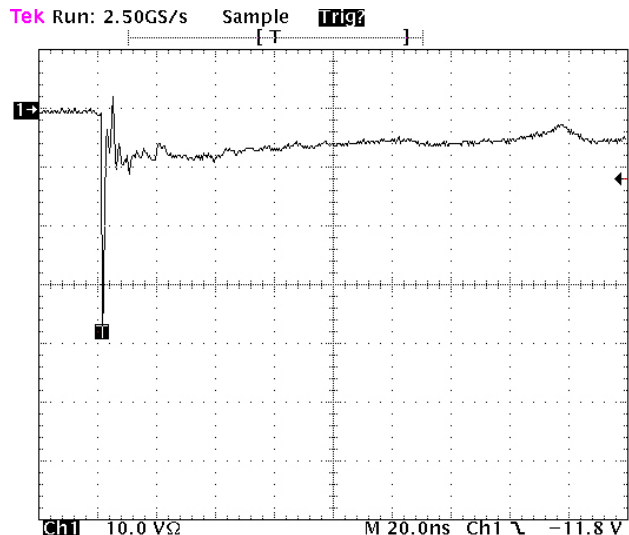

Figure 2. ESD Clamping Voltage Screenshot Negative 8 kV Contact per IEC61000-4-2

# ESD9B, SZESD9B

## IEC 61000-4-2 Spec.

| Level | Test Voltage (kV) | First Peak Current (A) | Current at 30 ns (A) | Current at 60 ns (A) |
|-------|-------------------|------------------------|----------------------|----------------------|
| 1     | 2                 | 7.5                    | 4                    | 2                    |
| 2     | 4                 | 15                     | 8                    | 4                    |
| 3     | 6                 | 22.5                   | 12                   | 6                    |
| 4     | 8                 | 30                     | 16                   | 8                    |



Figure 3. IEC61000-4-2 Spec

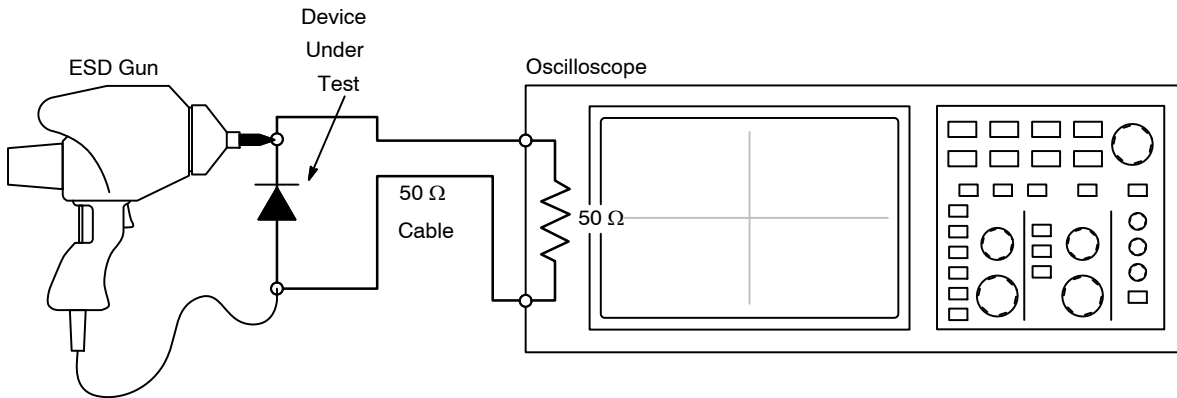

Figure 4. Diagram of ESD Test Setup

The following is taken from Application Note AND8308/D – Interpretation of Datasheet Parameters for ESD Devices.

### ESD Voltage Clamping

For sensitive circuit elements it is important to limit the voltage that an IC will be exposed to during an ESD event to as low a voltage as possible. The ESD clamping voltage is the voltage drop across the ESD protection diode during an ESD event per the IEC61000-4-2 waveform. Since the IEC61000-4-2 was written as a pass/fail spec for larger

systems such as cell phones or laptop computers it is not clearly defined in the spec how to specify a clamping voltage at the device level. ON Semiconductor has developed a way to examine the entire voltage waveform across the ESD protection diode over the time domain of an ESD pulse in the form of an oscilloscope screenshot, which can be found on the datasheets for all ESD protection diodes. For more information on how ON Semiconductor creates these screenshots and how to interpret them please refer to AND8307/D.

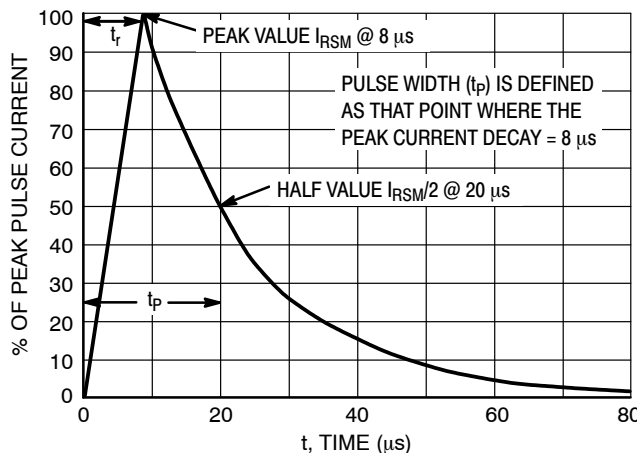

Figure 5. 8 x 20 μs Pulse Waveform

# MECHANICAL CASE OUTLINE

## PACKAGE DIMENSIONS

ON Semiconductor®



STYLE 1    STYLE 2

SCALE 8:1

**SOD-923**  
CASE 514AB  
ISSUE D

DATE 03 SEP 2020

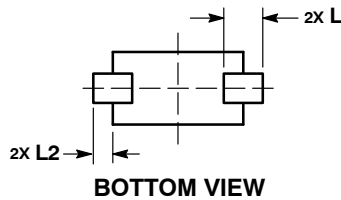
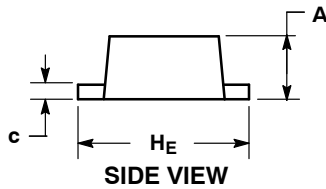
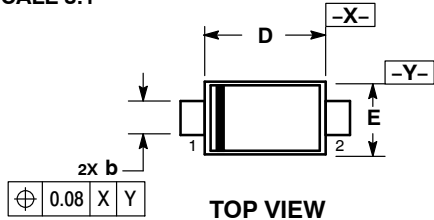

**SOLDERING FOOTPRINT\***

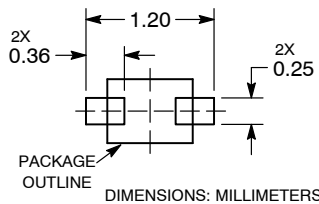

**NOTES:**

1. DIMENSIONING AND TOLERANCING PER ASME Y14.5M, 1994.
2. CONTROLLING DIMENSION: MILLIMETERS.
3. MAXIMUM LEAD THICKNESS INCLUDES LEAD FINISH. MINIMUM LEAD THICKNESS IS THE MINIMUM THICKNESS OF BASE MATERIAL.
4. DIMENSIONS D AND E DO NOT INCLUDE MOLD FLASH, PROTRUSIONS, OR GATE BURRS.
5. DIMENSION L WILL NOT EXCEED 0.30mm.

| DIM            | MILLIMETERS |      |      | INCHES    |       |       |
|----------------|-------------|------|------|-----------|-------|-------|
|                | MIN         | NOM  | MAX  | MIN       | NOM   | MAX   |
| A              | 0.34        | 0.37 | 0.40 | 0.013     | 0.015 | 0.016 |
| b              | 0.15        | 0.20 | 0.25 | 0.006     | 0.008 | 0.010 |
| c              | 0.07        | 0.12 | 0.17 | 0.003     | 0.005 | 0.007 |
| D              | 0.75        | 0.80 | 0.85 | 0.030     | 0.031 | 0.033 |
| E              | 0.55        | 0.60 | 0.65 | 0.022     | 0.024 | 0.026 |
| H <sub>E</sub> | 0.95        | 1.00 | 1.05 | 0.037     | 0.039 | 0.041 |
| L              | 0.19 REF    |      |      | 0.007 REF |       |       |
| L2             | 0.05        | 0.10 | 0.15 | 0.002     | 0.004 | 0.006 |

**GENERIC MARKING DIAGRAM\***

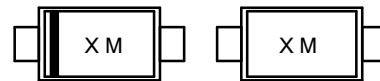

STYLE 1

STYLE 2

X = Specific Device Code  
M = Date Code

\*This information is generic. Please refer to device data sheet for actual part marking. Pb-Free indicator, "G" or microdot "▪", may or may not be present.

STYLE 1: PIN 1. CATHODE (POLARITY BAND)  
2. ANODE

STYLE 2: NO POLARITY

See Application Note AND8455/D for more mounting details

\*For additional information on our Pb-Free strategy and soldering details, please download the ON Semiconductor Soldering and Mounting Techniques Reference Manual, SOLDERRM/D.

|                         |   |  |
|-------------------------|---|--|
| <b>DOCUMENT NUMBER:</b> | <b>98AON23284D</b>                            | Electronic versions are uncontrolled except when accessed directly from the Document Repository. Printed versions are uncontrolled except when stamped "CONTROLLED COPY" in red. |
| <b>DESCRIPTION:</b>     | <b>SOD-923, 1.0X0.6X0.37, MAX HEIGHT 0.40</b> | <b>PAGE 1 OF 1</b>   |

ON Semiconductor and are trademarks of Semiconductor Components Industries, LLC dba ON Semiconductor or its subsidiaries in the United States and/or other countries. ON Semiconductor reserves the right to make changes without further notice to any products herein. ON Semiconductor makes no warranty, representation or guarantee regarding the suitability of its products for any particular purpose, nor does ON Semiconductor assume any liability arising out of the application or use of any product or circuit, and specifically disclaims any and all liability, including without limitation special, consequential or incidental damages. ON Semiconductor does not convey any license under its patent rights nor the rights of others.

**onsemi**, **Onsemi**, and other names, marks, and brands are registered and/or common law trademarks of Semiconductor Components Industries, LLC dba "**onsemi**" or its affiliates and/or subsidiaries in the United States and/or other countries. **onsemi** owns the rights to a number of patents, trademarks, copyrights, trade secrets, and other intellectual property. A listing of **onsemi**'s product/patent coverage may be accessed at [www.onsemi.com/site/pdf/Patent-Marking.pdf](http://www.onsemi.com/site/pdf/Patent-Marking.pdf). **onsemi** reserves the right to make changes at any time to any products or information herein, without notice. The information herein is provided "as-is" and **onsemi** makes no warranty, representation or guarantee regarding the accuracy of the information, product features, availability, functionality, or suitability of its products for any particular purpose, nor does **onsemi** assume any liability arising out of the application or use of any product or circuit, and specifically disclaims any and all liability, including without limitation special, consequential or incidental damages. Buyer is responsible for its products and applications using **onsemi** products, including compliance with all laws, regulations and safety requirements or standards, regardless of any support or applications information provided by **onsemi**. "Typical" parameters which may be provided in **onsemi** data sheets and/or specifications can and do vary in different applications and actual performance may vary over time. All operating parameters, including "Typicals" must be validated for each customer application by customer's technical experts. **onsemi** does not convey any license under any of its intellectual property rights nor the rights of others. **onsemi** products are not designed, intended, or authorized for use as a critical component in life support systems or any FDA Class 3 medical devices or medical devices with a same or similar classification in a foreign jurisdiction or any devices intended for implantation in the human body. Should Buyer purchase or use **onsemi** products for any such unintended or unauthorized application, Buyer shall indemnify and hold **onsemi** and its officers, employees, subsidiaries, affiliates, and distributors harmless against all claims, costs, damages, and expenses, and reasonable attorney fees arising out of, directly or indirectly, any claim of personal injury or death associated with such unintended or unauthorized use, even if such claim alleges that **onsemi** was negligent regarding the design or manufacture of the part. **onsemi** is an Equal Opportunity/Affirmative Action Employer. This literature is subject to all applicable copyright laws and is not for resale in any manner.

## PUBLICATION ORDERING INFORMATION

### LITERATURE FULFILLMENT:

Email Requests to: [orderlit@onsemi.com](mailto:orderlit@onsemi.com)

**onsemi Website:** [www.onsemi.com](http://www.onsemi.com)

### TECHNICAL SUPPORT

**North American Technical Support:**

Voice Mail: 1 800-282-9855 Toll Free USA/Canada

Phone: 011 421 33 790 2910

**Europe, Middle East and Africa Technical Support:**

Phone: 00421 33 790 2910

For additional information, please contact your local Sales Representative